

# burhéns

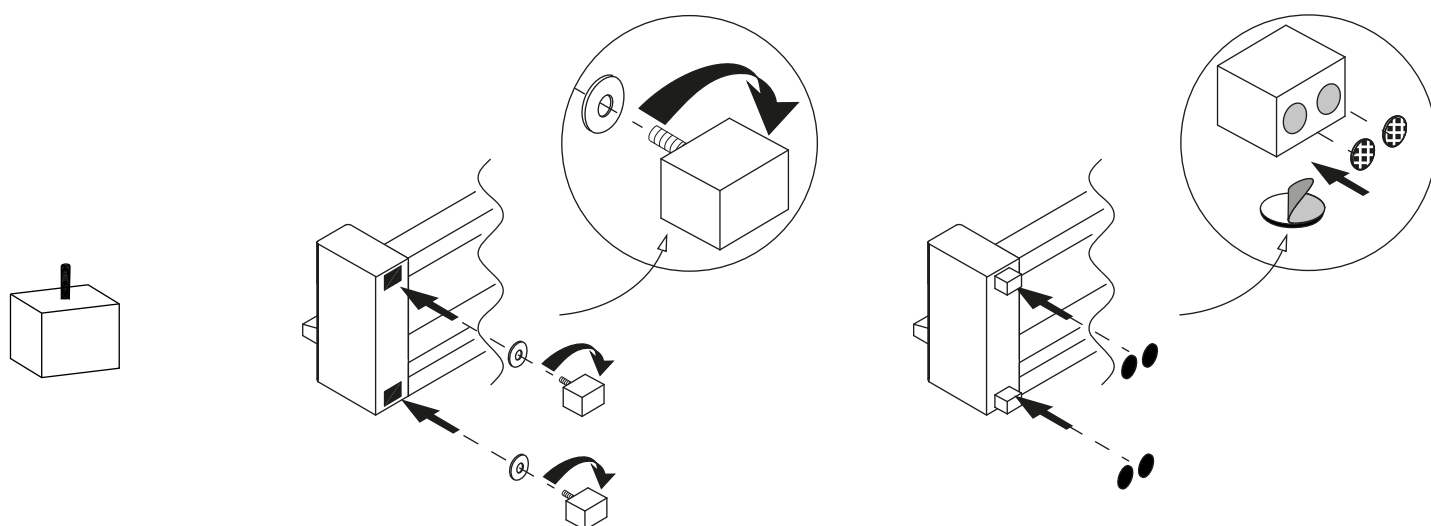
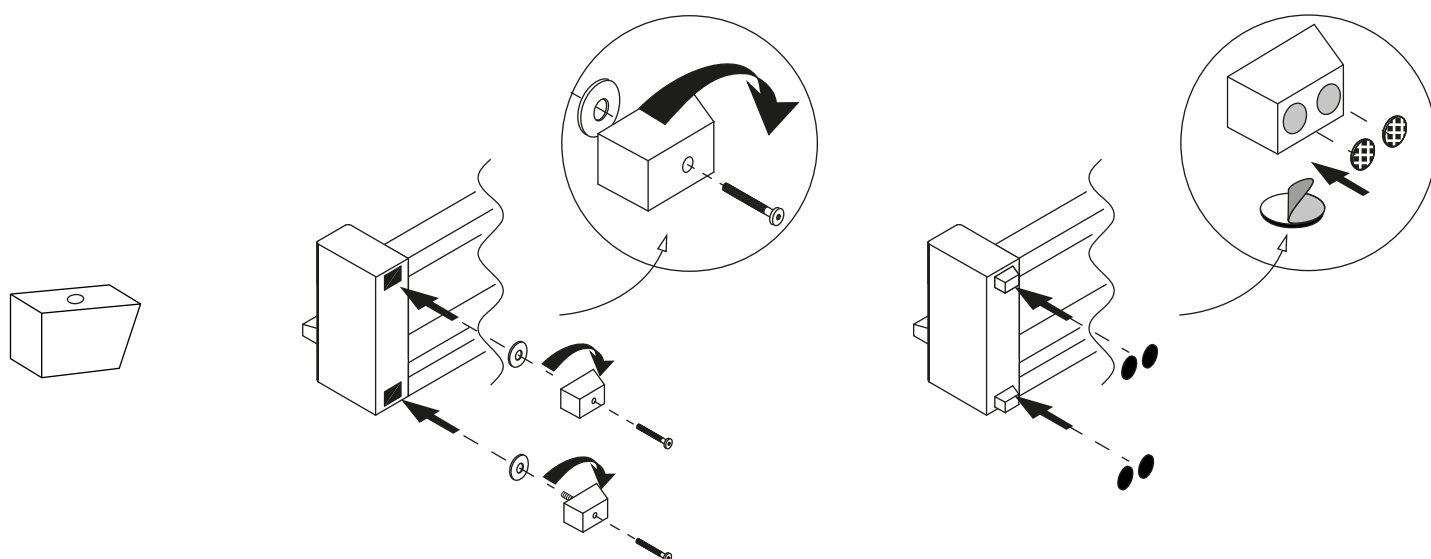
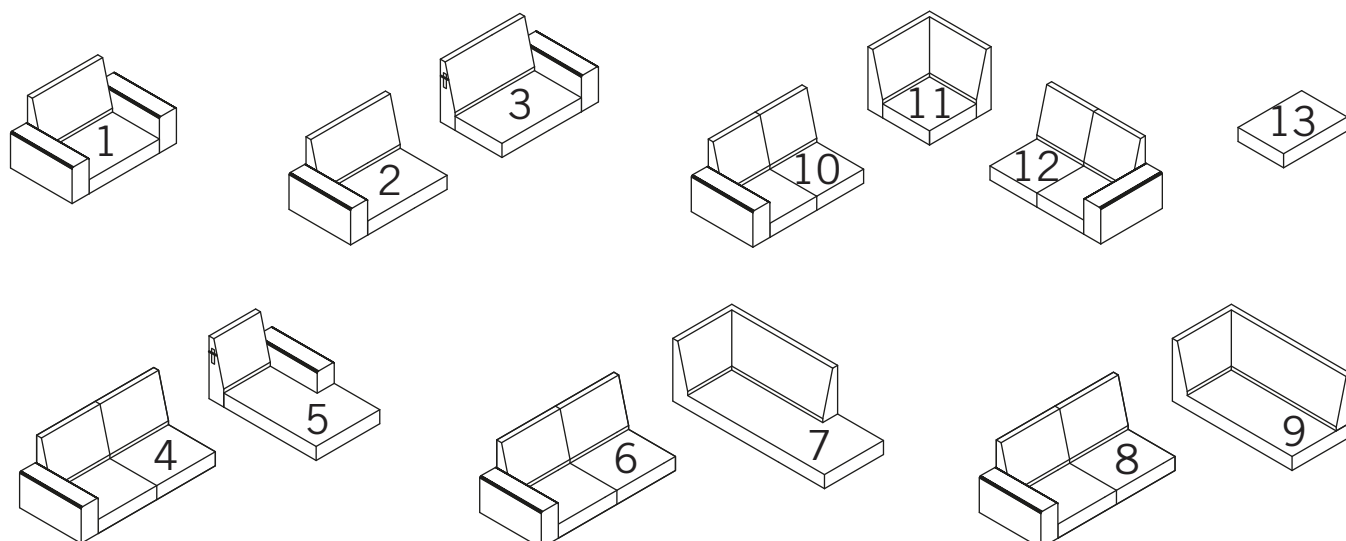

The frame is used for a variety of models and therefore there can be screw holes that are not relevant for your sofa.

## A 1: 1,5-SEATER, 2,5-MODULE, 3-MODULE

4x 

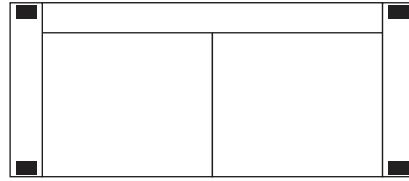
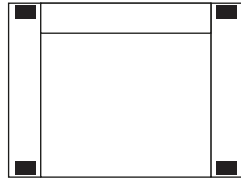

## B 2+3: 3,5-SEATER

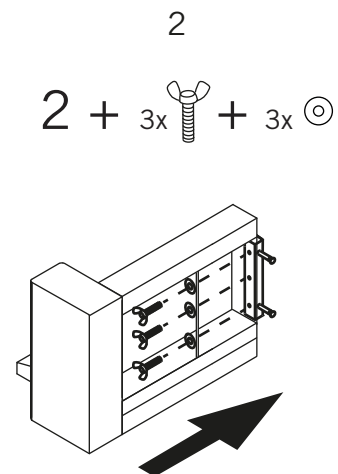
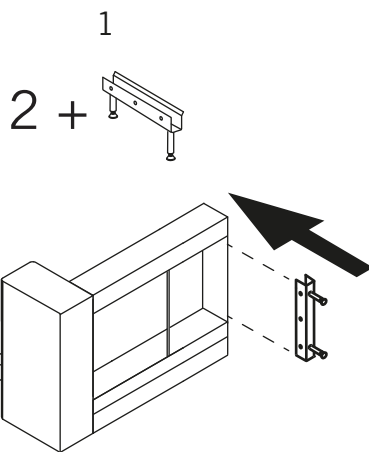

## C 2 + 3

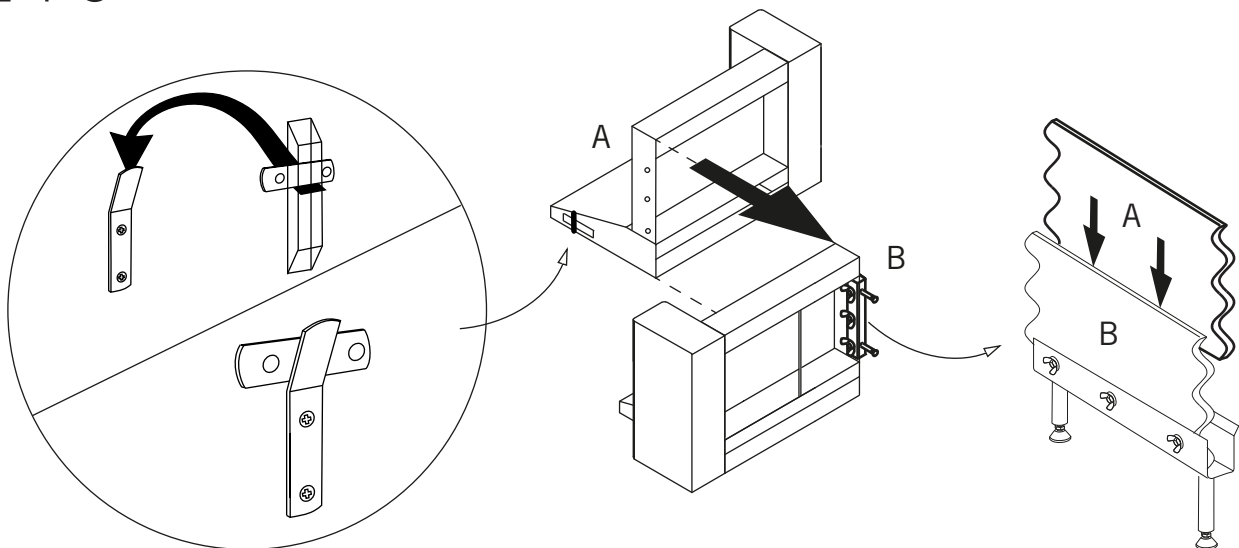

The frame is used for a variety of models and therefore there can be screw holes that are not relevant for your sofa.

D

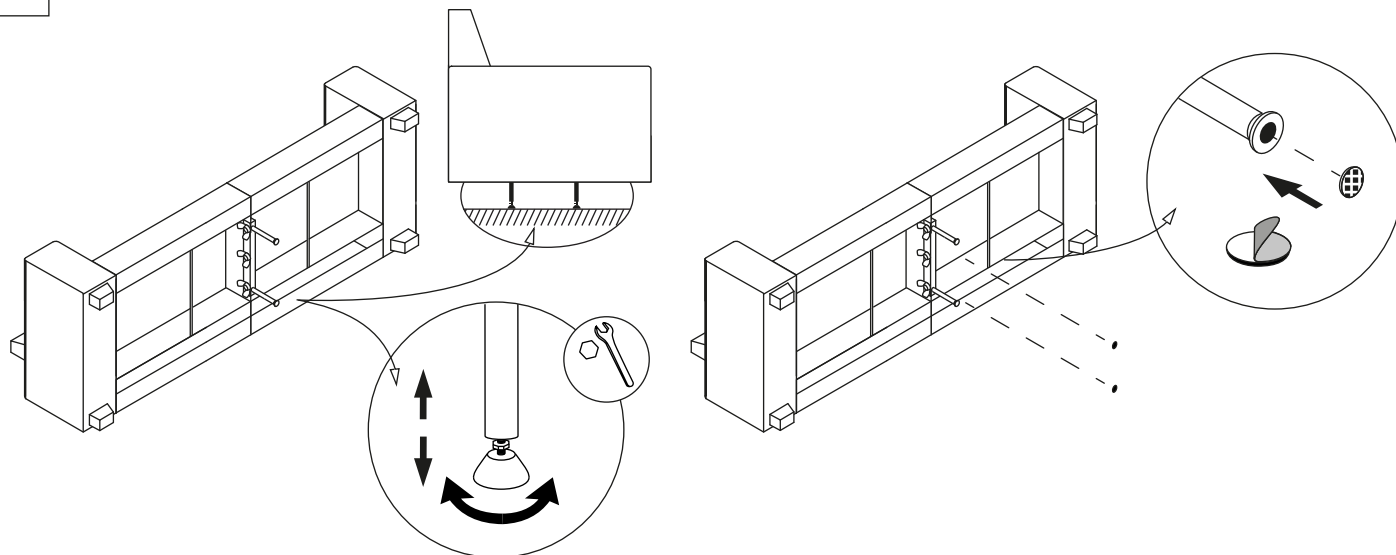

E

4x  

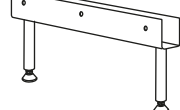
1x  

TOP VIEW

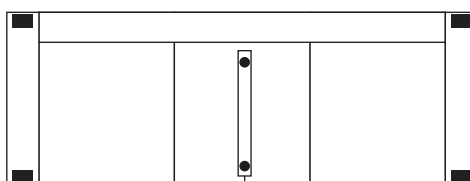

F 4+5: 1,5+CHL, 2,5+CHL

6x  

2x  

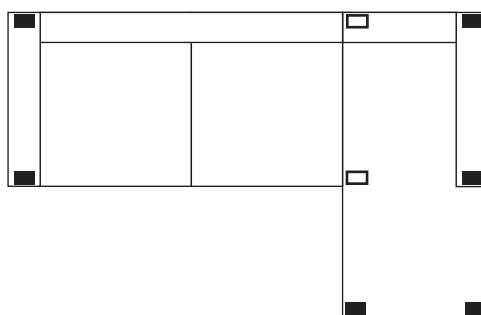
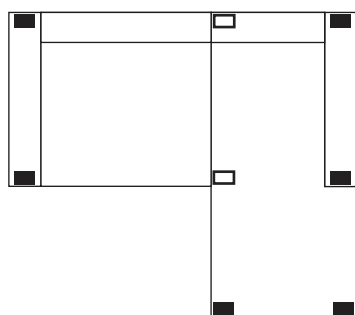

The frame is used for a variety of models and therefore there can be screw holes that are not relevant for your sofa.

G

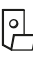
5 + 2x  + 2x   
3 cm

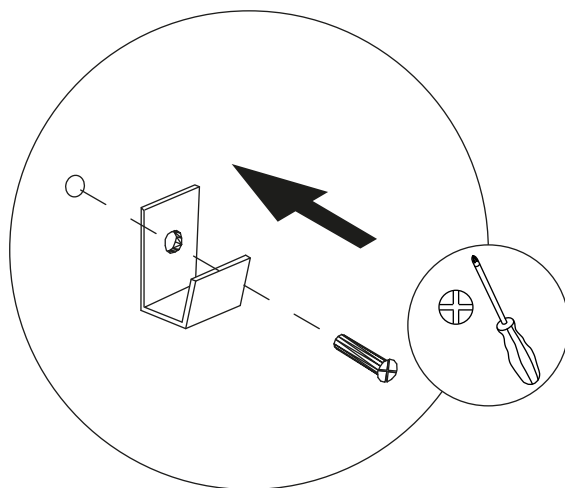
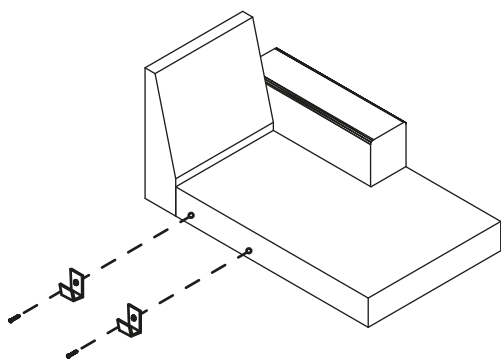

H

4 + 5

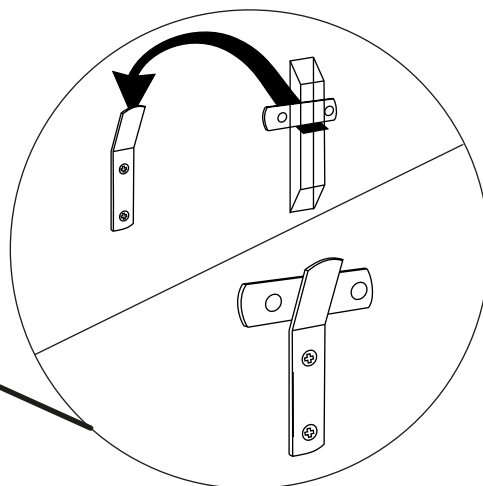
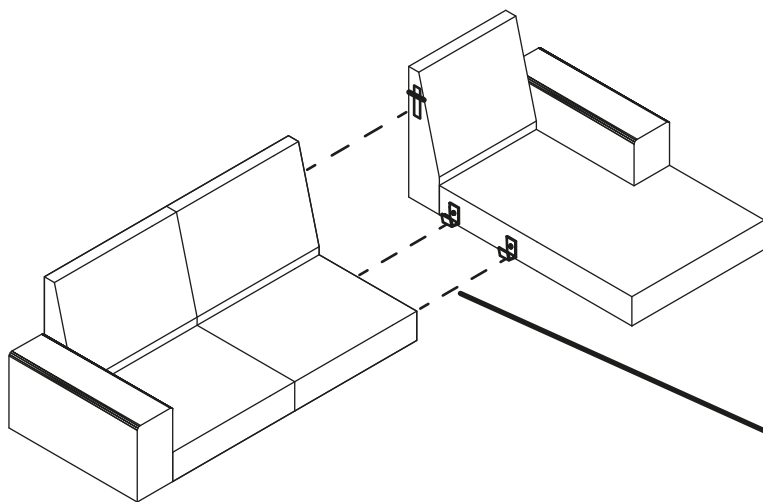

I



6+7: 1,5+DIVAN, 2,5+DIVAN

5x 

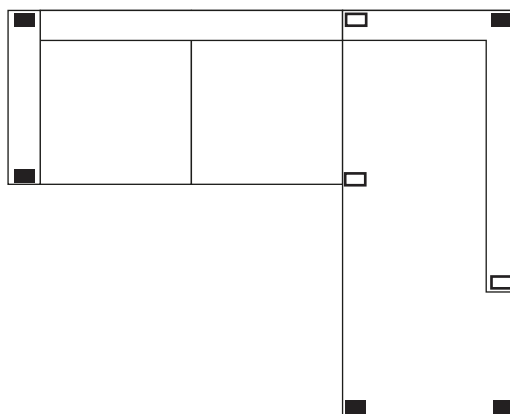
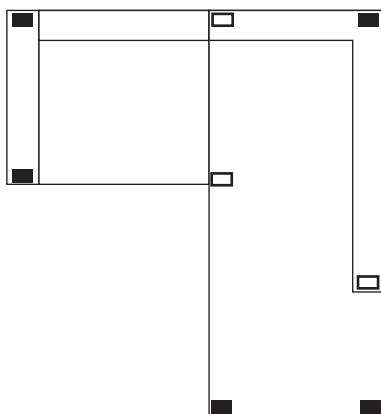
3x 



J

7 + 2x  + 2x   
3 cm

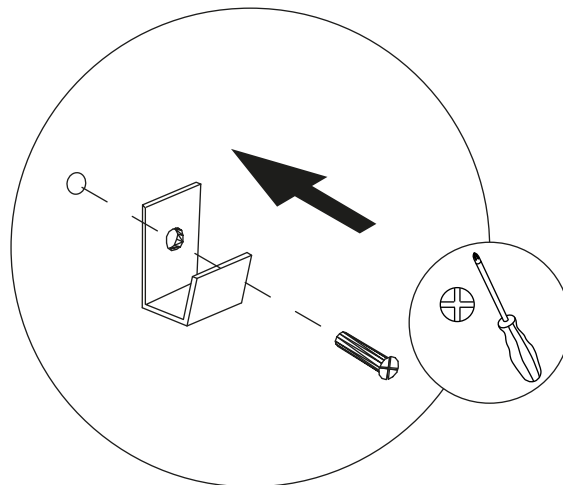
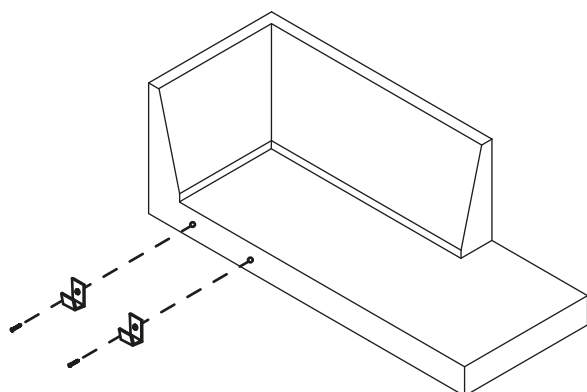

K

6 + 7

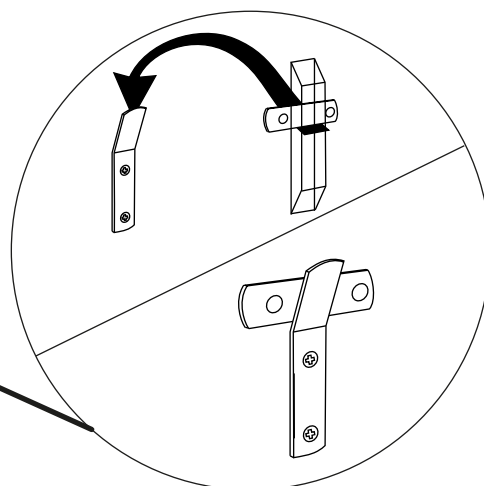
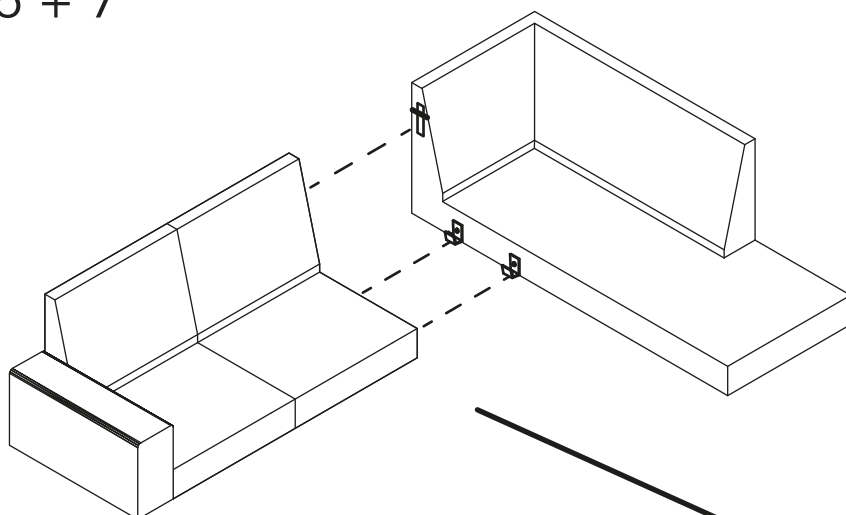

L



8+9: 1,5+COSY, 2,5+COSY

5x 

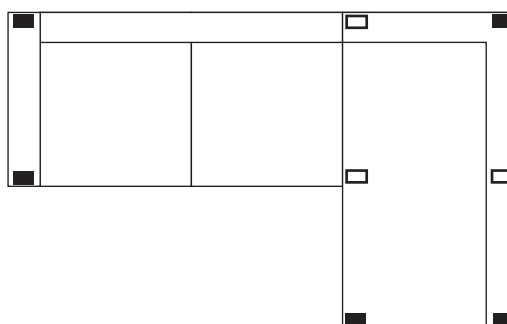
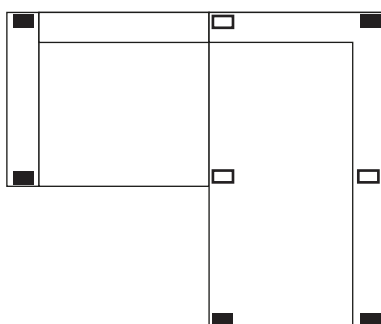
3x 



M

9 + 2x  + 2x   
3 cm

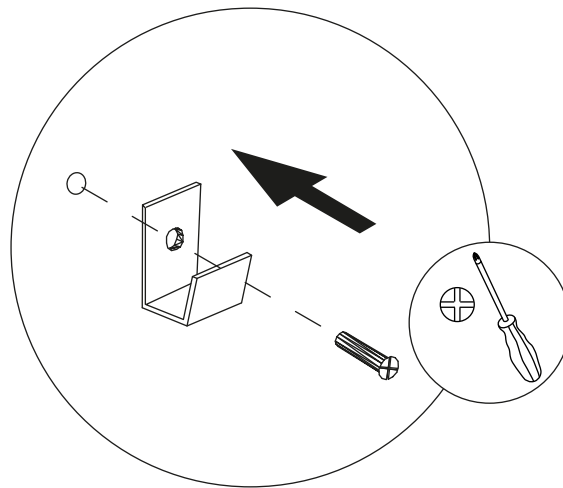
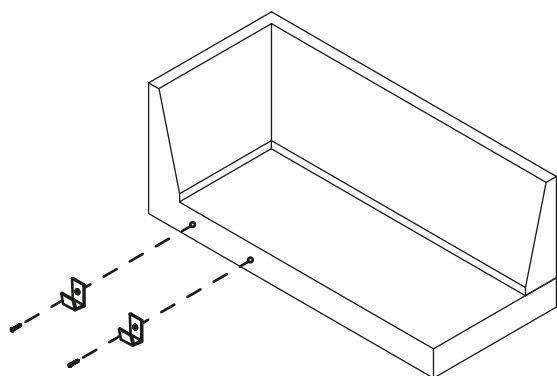

N

8 + 9

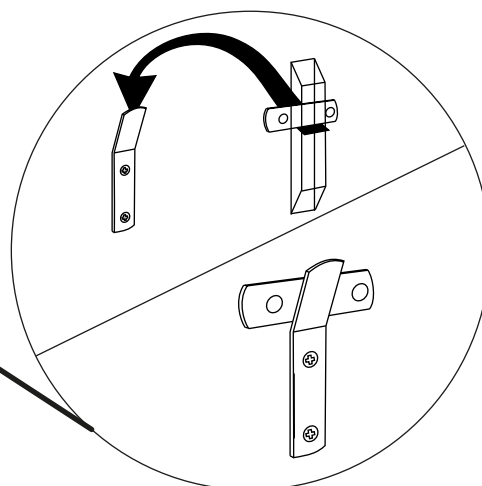
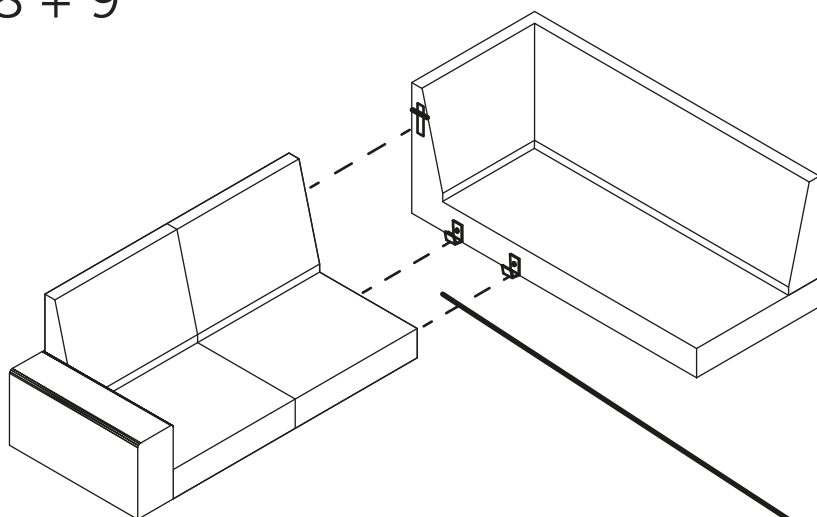

O

13: FOOTSTOOL 1

4x 

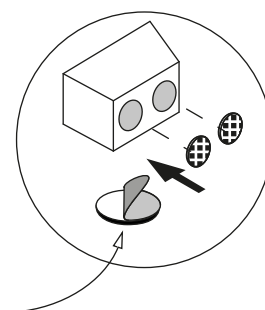
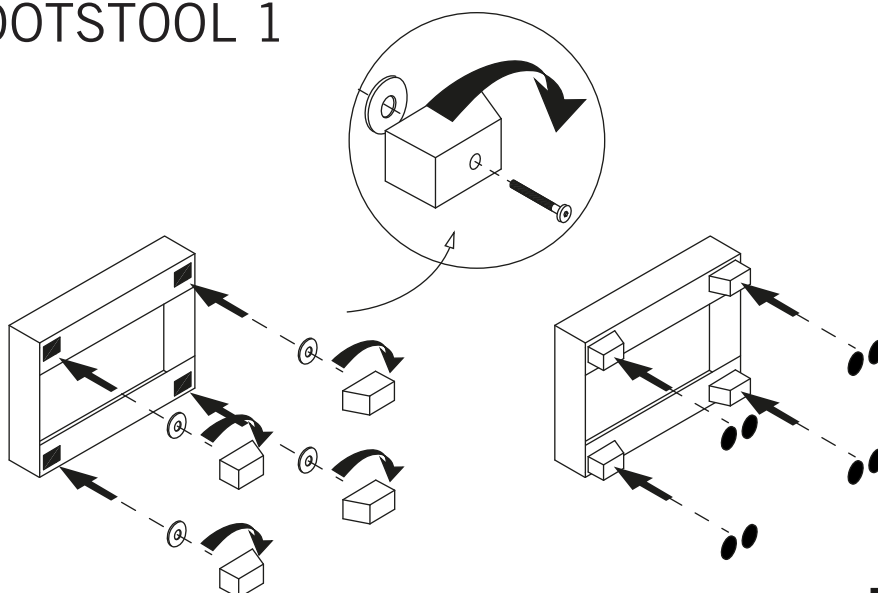

burhéns